

Gesso

Typical 65-8

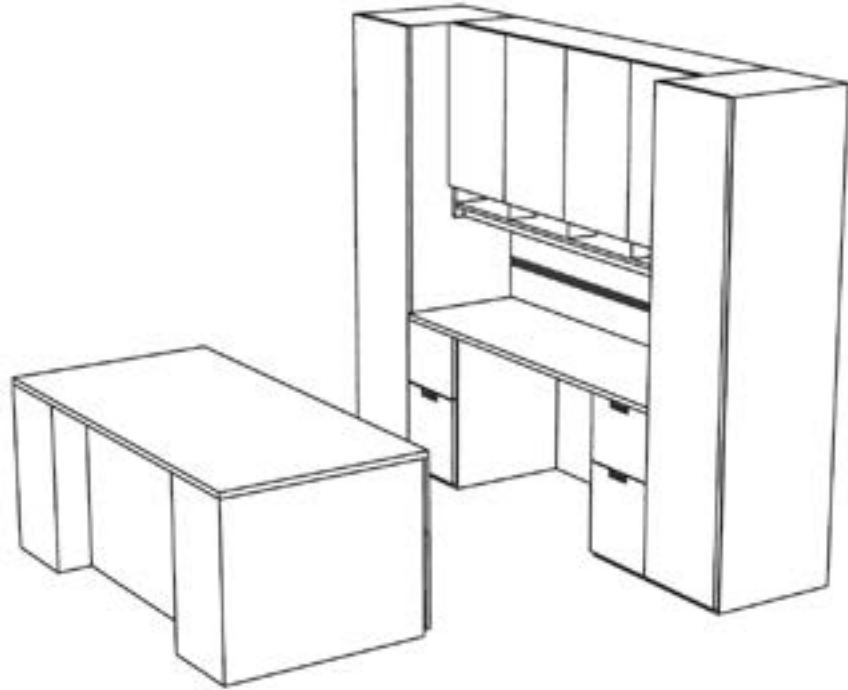

Model #	Qty	Description	List Price	Total
65-1572TWDS	1	Tall Wall Mount Door Hutch w/Paper Slots	\$3,959	\$3,959
65-1884WL	1	Tall Wardrobe/Storage Cabinet - Left	\$2,618	\$2,618
65-1884WR	1	Tall Wardrobe/Storage Cabinet - Right	\$2,618	\$2,618
67-2472KC	1	Kneespace Credenza, File/File	\$3,293	\$3,293
67-3672DPS	1	Double Pedestal Desk Rectangular Top, Stepped Front	\$3,982	\$3,982
WW-1972TRWPS	1	Tool Rail Work Wall (<i>Grade 1</i>)	\$691	\$691
TL-0848	1	Task Light	\$306	\$306
TOTAL LIST				\$17,467

Prices based on February 2020 Price List. Excludes Accessories and Seating.

Indiana
FURNITURE

800.422.5727 IndianaFurniture.com

Gesso

Typical 65-9

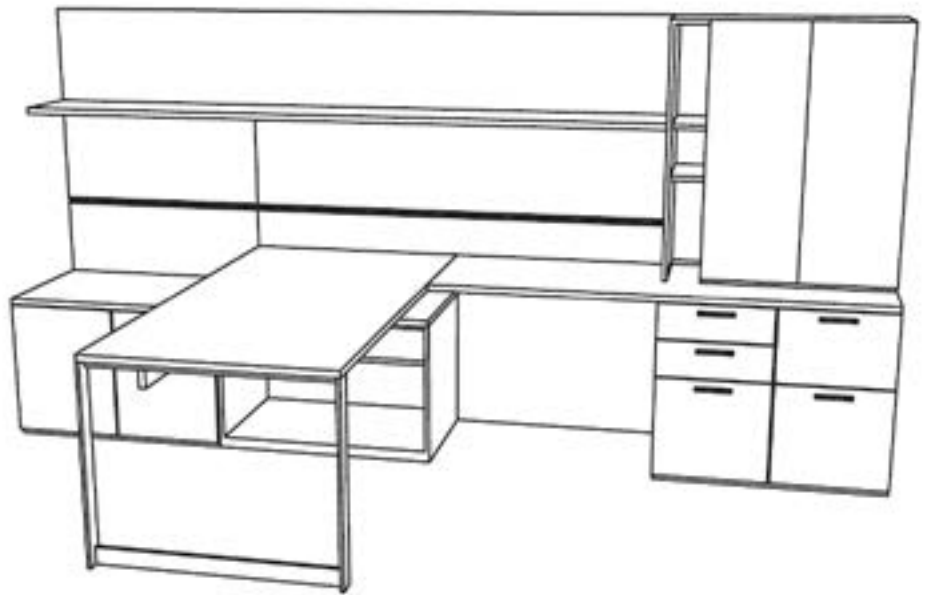

Model #	Qty	Description	List Price	Total
65-15108LS	1	Open Wall Mount L-Shelf	\$1,538	\$1,538
65-2436L21BC	1	21" Low Modular Open Storage	\$1,347	\$1,347
65-2436L21DB	1	21" Low Modular Door Bookcase	\$1,536	\$1,536
65-1807USP21	1	Layer Support Over Low Height Cabinets	\$314	\$314
65-7220BP	1	Low Height Back Panel	\$523	\$523
65-3615TUDBL	1	Top Unit Door Bookcase	\$2,540	\$2,540
01-3628BL	1	Seated Height Modular Peninsula Support (<i>Aluminum</i>)	\$493	\$493
65-6807MOD	1	7" Veneer Modesty Panel	\$495	\$495
65-2418PD1	1	Modular Pedestal Box/Box/File	\$1,522	\$1,522
65-2418PD2	1	Modular Pedestal File/File	\$1,522	\$1,522
65-2472TP	2	Modular Cabinet Tops	\$725	\$1,450
65-3672TP	1	Modular Desk Top	\$883	\$883
65-7228BP	1	Modular Modesty Panel	\$604	\$604
WW-3136TTRW	1	Tool Rail Work Wall (<i>Grade 1</i>)	\$648	\$648
WW-2372TRW	1	Tool Rail Work Wall (<i>Grade 1</i>)	\$756	\$756
TOTAL LIST			\$16,171	

Prices based on February 2020 Price List. Excludes Accessories and Seating.

Indiana
FURNITURE

800.422.5727 IndianaFurniture.com

Gesso

Typical 65-10



Model #	Qty	Description	List Price	Total
01-3028BL	2	Seated Height Modular Peninsula Support (<i>Aluminum</i>)	\$444	\$888
01-ACCTRAYC	1	Accessory Tray (<i>Clear</i>)	\$87	\$87
01-FLDRSRTRC	1	Tool Rail Folder Sorter (<i>Clear</i>)	\$89	\$89
01-LTRTRAYC	1	Letter Tray (<i>Clear</i>)	\$82	\$82
65-3020BP	1	Low Height Back Panel	\$326	\$326
65-7820BP	2	Low Height Back Panel	\$540	\$1,080
TB-3148W	2	Wall Mounted Hutch Tackboard (<i>Grade 1</i>)	\$412	\$824
WW-3148TTRW	2	Tool Rail Work Wall (<i>Grade 1</i>)	\$720	\$1,440
65-2018L21BF	2	21" Low Modular Box/File	\$1,269	\$2,538
65-2030L21BC	3	21" Low Modular Open Storage	\$1,235	\$3,705
65-2030L21BF	2	21" Low Modular Box/File	\$1,496	\$2,992
65-2078TP	2	Modular Cabinet Top	\$664	\$1,328
65-2030TP	1	Modular Cabinet Top	\$388	\$388
65-1578WD	2	Wall Mount Door Hutch	\$2,609	\$5,218
65-1530OW	1	Wall Mount Open Hutch	\$996	\$996
TL-0824	1	Task Light	\$254	\$254
TL-0848	2	Task Light	\$306	\$612
65-3060TP	2	Modular Top Desk	\$733	\$1,466
65-5607MOD	2	7" Veneer Modesty Panel	\$478	\$956
65-1807USP21	2	Layer Support Over Low Height Cabinets	\$314	\$628
65-3636CT	1	Circular Top	\$757	\$757
08-2030SXB	1	Small X Base (<i>Aluminum</i>)	\$784	\$784
TOTAL LIST			\$27,438	

Prices based on February 2020 Price List. Excludes Accessories and Seating.

Indiana
FURNITURE

800.422.5727 IndianaFurniture.com

Gesso

Typical 65-11

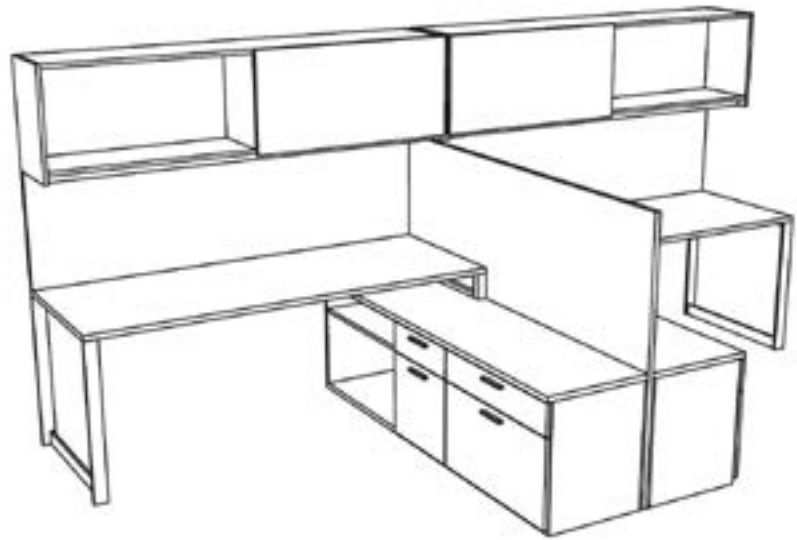

Model #	Qty	Description	List Price	Total
01-2428BL	2	Seated Height Modular Peninsula Support (<i>Aluminum</i>)	\$414	\$828
TB-6578W	2	Wall Mounted Hutch Tackboard (Grade 1)	\$480	\$960
65-2018L21BC	2	21" Low Modular Open Storage	\$1,125	\$2,250
65-2036L21BF	2	21" Low Modular Box/File	\$1,560	\$3,120
65-2018L21BF	2	21" Low Modular Box/File	\$1,269	\$2,538
65-2072TP	2	Modular Cabinet Top	\$645	\$1,290
65-5172GS	1	Straight Floorstanding Gallery Screen	\$1,392	\$1,392
01-00060SB	2	Stiffener Bar	\$180	\$360
65-2003FP	2	Filler Panel	\$225	\$450
65-1578SWD	2	Wall Mounted Sliding Door Hutch	\$3,095	\$6,190
01-2407OL	2	Layer Support for Low Credenza (<i>Aluminum</i>)	\$360	\$720
65-2478TP	2	Modular Cabinet Top	\$746	\$1,492
TL-0848	2	Task Light	\$306	\$612
TOTAL LIST				\$22,202

Prices based on February 2020 Price List. Excludes Accessories and Seating.

Indiana
FURNITURE

800.422.5727 IndianaFurniture.com

Gesso

Typical 65-12

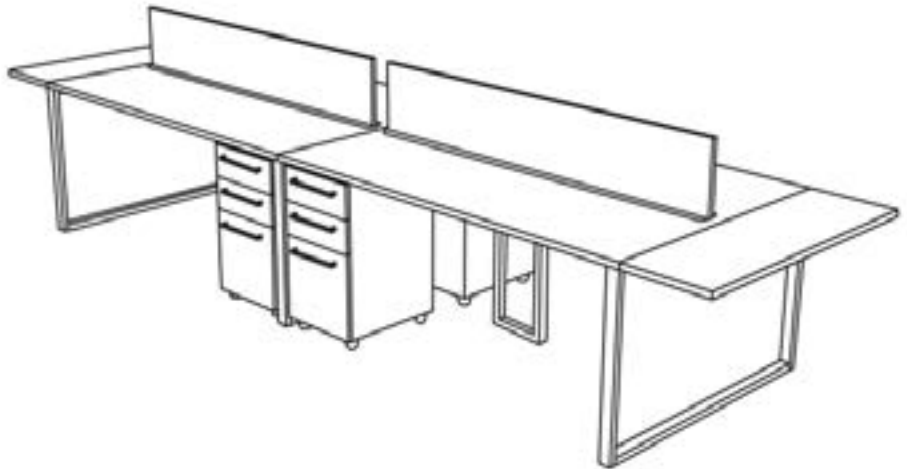

Model #	Qty	Description	List Price	Total
01-3028OLS	2	Seated Height Shared Metal Leg (<i>Aluminum</i>)	\$435	\$870
01-6028OL	2	Seated Height Modular Peninsula Support (<i>Aluminum</i>)	\$632	\$1,264
01-00060SB	4	Stiffener Bar	\$180	\$720
01-1228OL	2	O Leg Support (<i>Aluminum</i>)	\$304	\$608
65-1519MP2	4	Mobile Pedestal File/File	\$1,561	\$6,244
65-1560DTP	2	Desk Top Extensions	\$472	\$944
65-6072TP	2	Modular Desk Top	\$1,353	\$2,706
65-6812PP	2	12" Veneer Privacy Panel	\$524	\$1,048
TOTAL LIST				\$14,404

Prices based on February 2020 Price List. Excludes Accessories and Seating.

Indiana
FURNITURE

800.422.5727 IndianaFurniture.com